

User Manual



For the best experience,
please read this manual carefully.
We wish you an enjoyable experience.

Safety Precautions

This device is only suitable for people aged 18+; children, pregnant women and people with a heart disease, high blood pressure, diabetes, asthma or allergies to nicotine should never use this device.

This device is not waterproof. Please do not wash it with water nor leave it in a humid environment.

This device is to be used only with specially designed heat-not-burn (tobacco) sticks. If used with other products you may damage the device or be exposed to health risks.

Do not use this device in flammable or explosive environments such as petrol stations or chemical plants.

After heating, please do not disassemble the device and clean it immediately to avoid residue of getting burned.

When the device is charging or in use, or if the case gets overheated, please stop using the device immediately.

Product Introduction

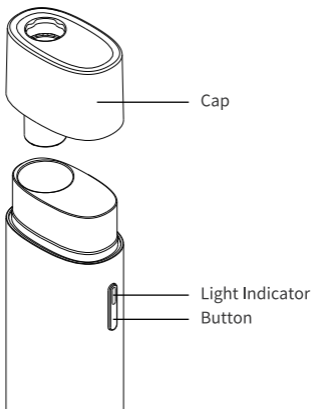

Heating element:	Pin
Pre-heating time:	20 s
Session time for 1 stick :	14 puffs / 5 min
Number of sessions on a fully charged battery:	≥23 sticks
Battery capacity:	1380 mAh
Size:	27*16*105 mm

Battery Checking

Tap the power-on button once to check the battery level.

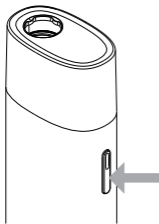

If the battery power is between 25%-100% the white LED is on; when at less than 25% an orange LED will appear; when the power left is for less than 1 stick, the orange LED will start flashing.



25%-100%



<25%



less than
1 stick

Charging

When charging for the first time, please connect the device to the dedicated charging cable and power adapter and fully charge it (about 120 minutes for a full charge).

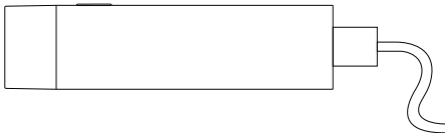

Charging Indicator



Less than 25%
Battery
power, Orange LED
is breathing



25%-100% Battery
power,
white LED is
breathing



The white LED is always
on
when fully charged, and
the LED turns off after 30
seconds

Caution:

When charging daily (including the first time), the correspondence between the power status and the lighting effect is shown above.

How to Use

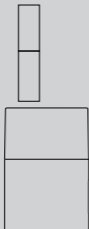

Insert the stick into
the top of the device.

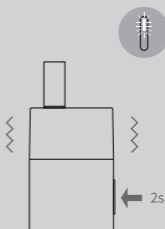

Press and hold the button
for 2 seconds, the device
will vibrate once while the
LED light will flash at the
same time; now the
pre-heating starts.

After 20 seconds the Pre-heating is over, the device vibrates once, and the white LED turns solid. Now you may start inhaling.

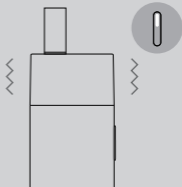

“End heating notice”: When there are 30 seconds left, the device will vibrate once, and the LED will turn to white and starts flashing; after that the heating ends and the LED turns off.

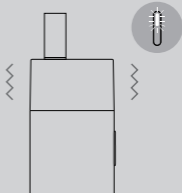

“Forced to stop heating”: Pressing the button for 2 seconds will manually stop the heating process. The device will vibrate once, after that the heating ends and the LED turns off.

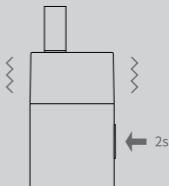

After finishing inhaling,
rotate the stick first.

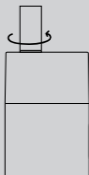

Pull out the cap.

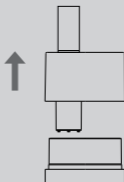

Remove the stick from
the cap.

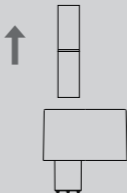

Caution:

Do not remove the stick directly after finishing your session, as it may break and leave residue inside the cap.

Please insert and remove the stick vertically to avoid damaging the heating element.

When the stick is in heating state, please do not rotate or remove to avoid damaging the heating element.

Cleaning the heating element

Caution:

Please read the cleaning instruction carefully to avoid the damage of the heater.

01



Prepare brush

02

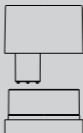

Remove the cap to reveal the pin

03

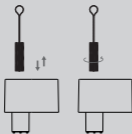

Clean the cap

04



Gently wipe the heating port and heating element with the brush

Caution:

- 01. Do not wipe the heating element by hand;
- 02. Do not stress the heating element.

Warning:

After using the device allow the heating element to cool down for 2-3 minutes before cleaning.
Do not touch or wipe the surface of the heating element with an acid solution.

Status Reminder

01. To lock the device, press the button 5 times; the device vibrates once and the white LED light flashes once. When the device vibrates twice and the LED light flashes twice at the same time, the device is unlocked and heating can be performed.

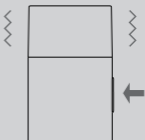

02. When the battery level is lower than 1 stick, the device vibrates 1 time and flashes in orange 3 times.



Error indicators

① If, during the heating process, the battery temperature is above 60°C or below -10°C, the device vibrates 1 time and flashes quickly in red 3 times.

If, when charging, the battery temperature is above 45°C or lower than 0°C, the device vibrates 1 time and flashes quickly in red 3 times.

② The coil does not work or the MOS tube is damaged (the coil is not welded well, and the heating process does not start): the device vibrates 1 time and flashes quickly in red 5 times. If, during the heating process, the temperature measuring circuit of the heating element fails, the device vibrates 1 time and flashes quickly in red 5 times.

Warning: Use by minors prohibited

